

PORT MELBOURNE 602D/134 Rouse Street

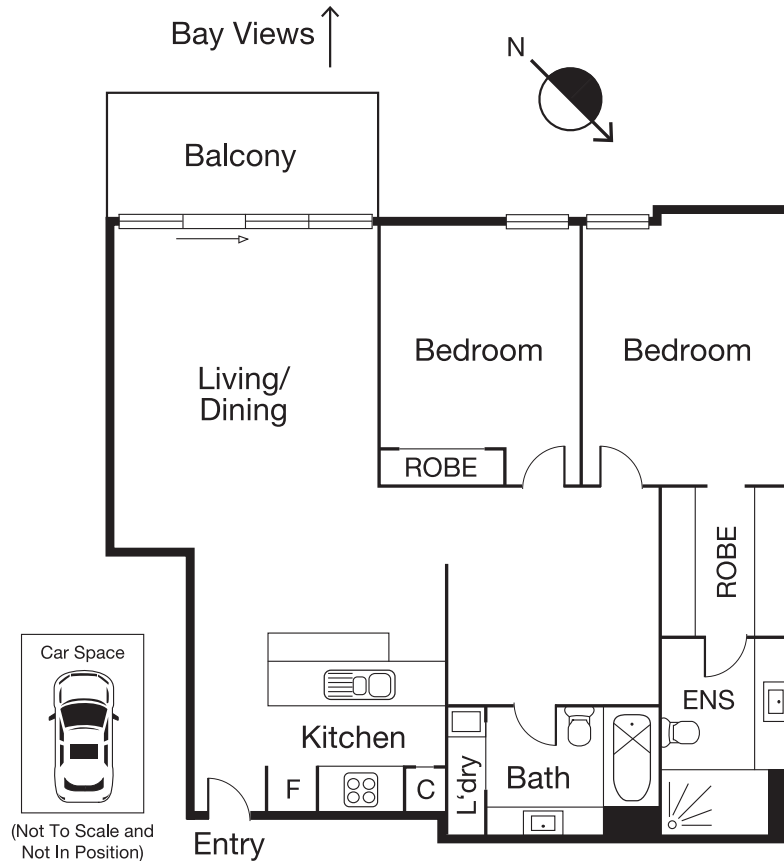

CAYZER

PORT MELBOURNE 602D/134 Rouse Street



PRIME PORT MELBOURNE LIVING

- Located in the highly sought-after Bayview building.
- Walk to the sunny sandy beaches
- Be part of the energetic cafe scene of Bay Street

Generously sized, two bedrooms run off a central alcove that can be purposed as a study or sitting room. The master taking advantage of water views and includes a walk-in robe and ensuite. Bayview has become a building renowned for its first-class facilities and diligent management. Including a lap pool, spa, sauna, gym, podium gardens and numerous visitor car parks, Bayview is a building constructed with the owner-occupier in mind.

Opportunities in the building are rare and offerings of this quality even more so. Don't miss your chance to become a resident of Bayview.

 2  2  1

Auction Saturday 1st December at 11am

Inspection As advertised or by appointment

Contact Jordan Gravestain 0448 250 193
Jason De Stefano 0413 292 666
Michael Szulc 0417 122 809

Mel Ref 57 B3



Interactive Floorplan

CAYZER

Albert Park 330 Montague Street 03 9699 5999
Port Melbourne 370 Bay Street 03 9646 0812

cayzer.com.au